

**CONCRETE ISLAND ON EXISTING PAVEMENT**

CD-606-3.1

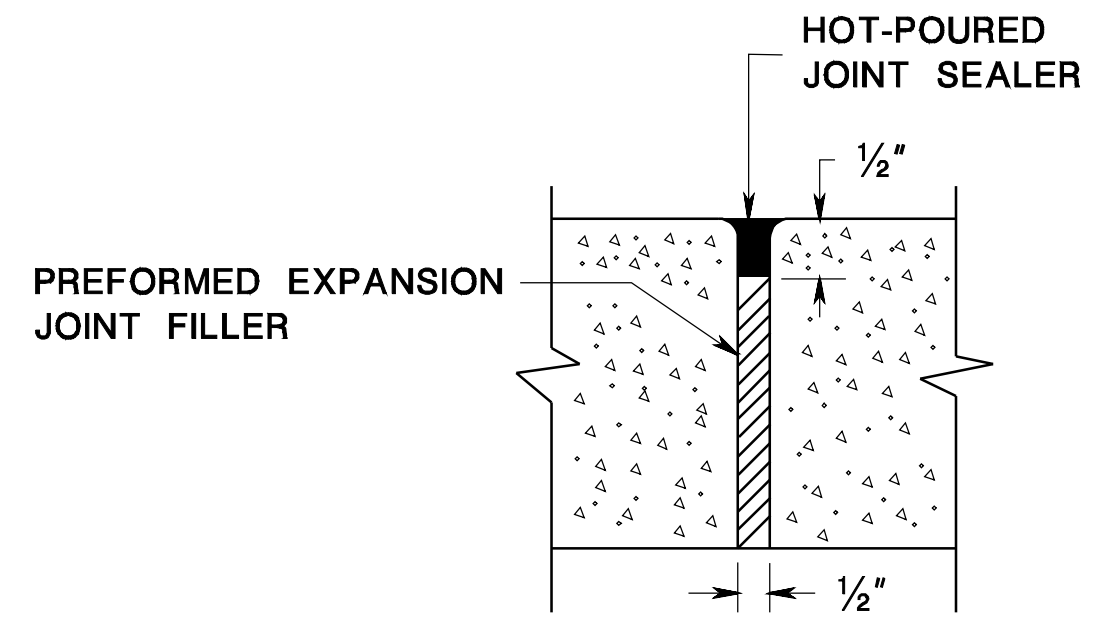

**LONGITUDINAL & TRANSVERSE JOINT TREATMENT FOR CONCRETE ISLAND**

CD-606-3.2

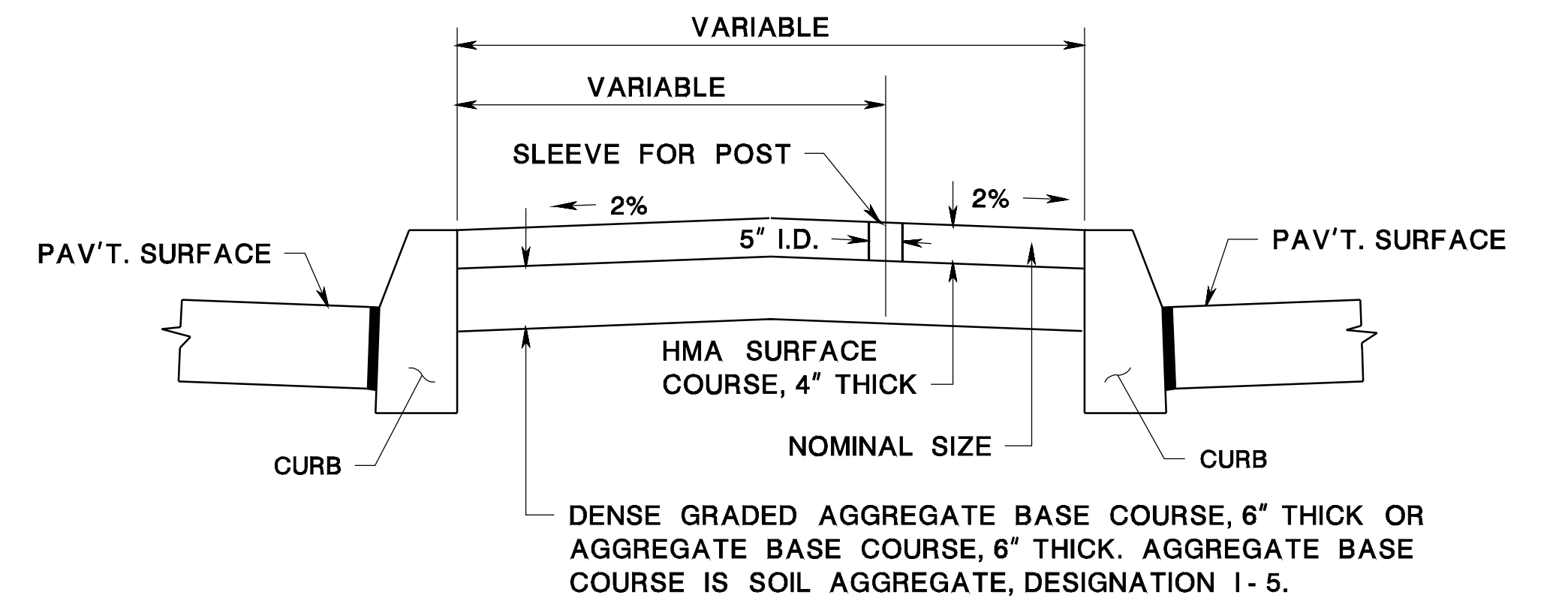

**HMA ISLAND, 10\"/>**

CD-606-3.3

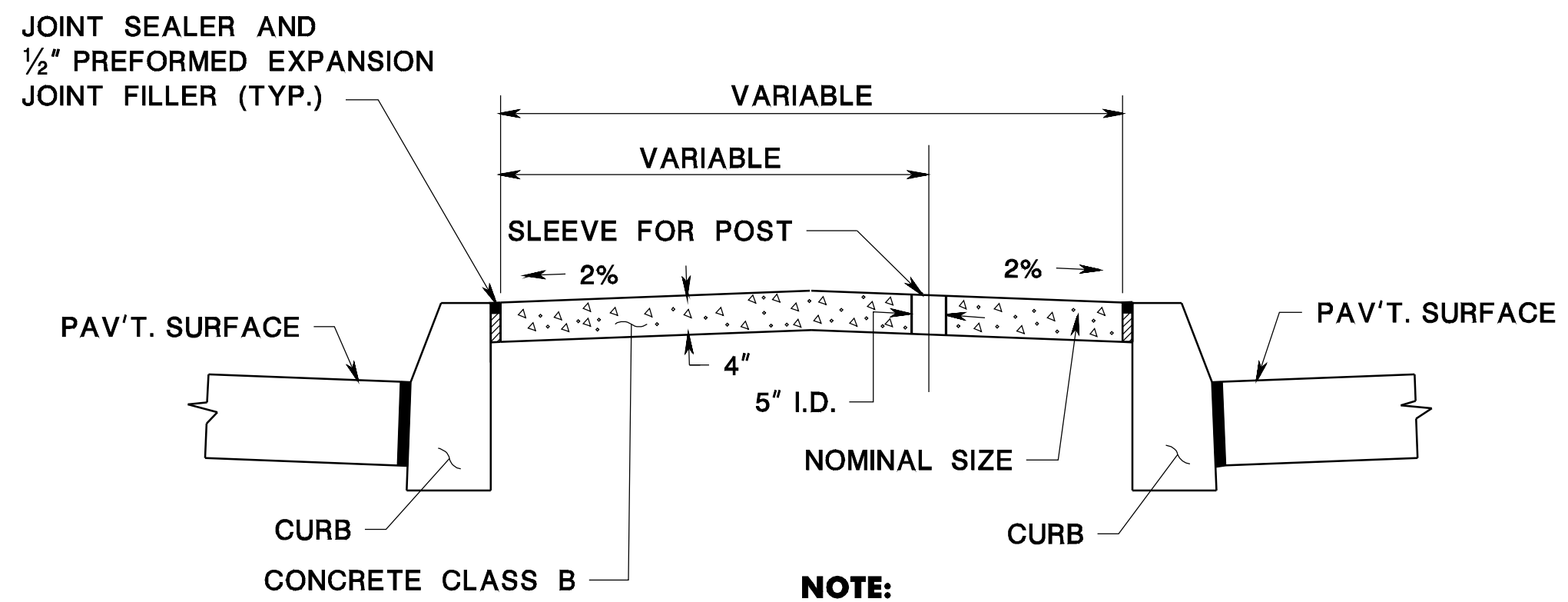

**CONCRETE ISLAND, 4\"/>**

CD-606-3.4

**NOTE:**  
TRANSVERSE JOINTS SHALL BE AS CONSTRUCTED FOR CONCRETE VERTICAL CURB.

**CONCRETE AND HMA ISLAND**

N.T.S.

HMA = HOT MIX ASPHALT

CD-606-3

NEW JERSEY DEPARTMENT OF TRANSPORTATION

**CONSTRUCTION DETAILS**