

ROUTE 559 ALTERNATE (South to North)

Mile Posts: 0.000 - 2.000

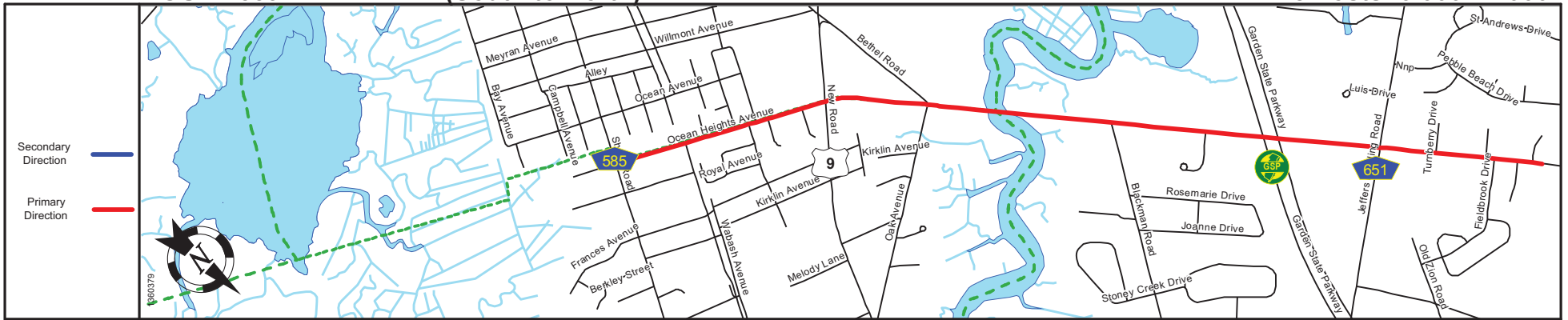

Pavement	
Shoulder	
Number of Lanes	
Speed Limit	
Street Name	

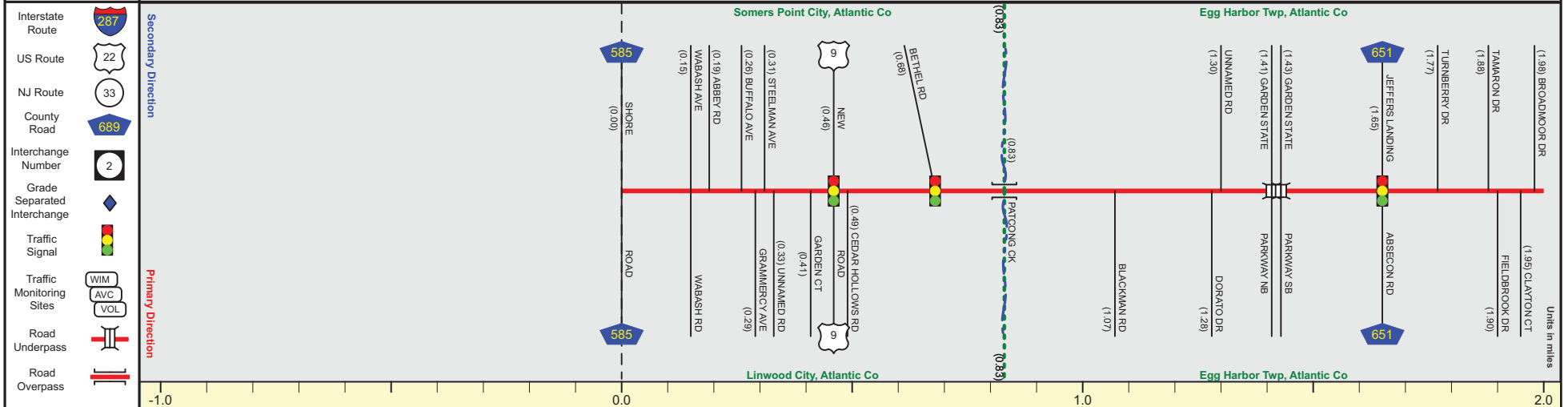

Street Name	Ocean Heights Avenue				
Jurisdiction	County				
Functional Class	Urban Major Collector		Urban Minor Arterial		
Federal Aid - NHS Sy	STP				
Control Section					
Speed Limit	25	35	45	50	
Number of Lanes	2				
Med. Type	None				
Med. Width	0				
Pavement	24		22		
Shoulder	1	2	4		
Traffic Volume	4,308 (2016)	5,633 (2018)	19,334 (2016)	16,305 (2017)	
Traffic Sta. ID	8-7-281	8-8-282	8-8-283	8-8-294	
Structure No.			01E4033	360316S 360316N	
Enlarged Views					

SRI = 0000559A_

Date last inventoried: June 2012

ROUTE 559 ALTERNATE (South to North)

Mile Posts: 2.000 - 5.000

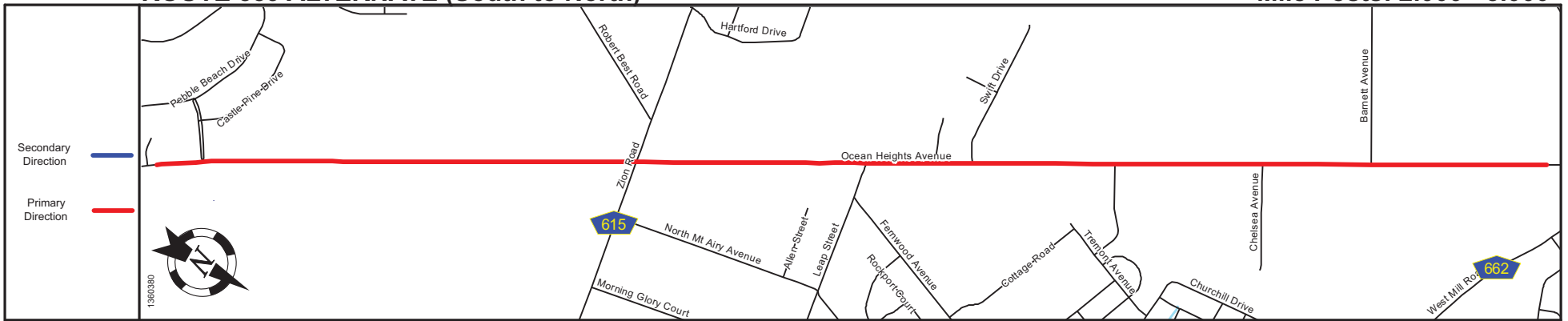

Pavement	
Shoulder	
Number of Lanes	
Speed Limit	
Street Name	

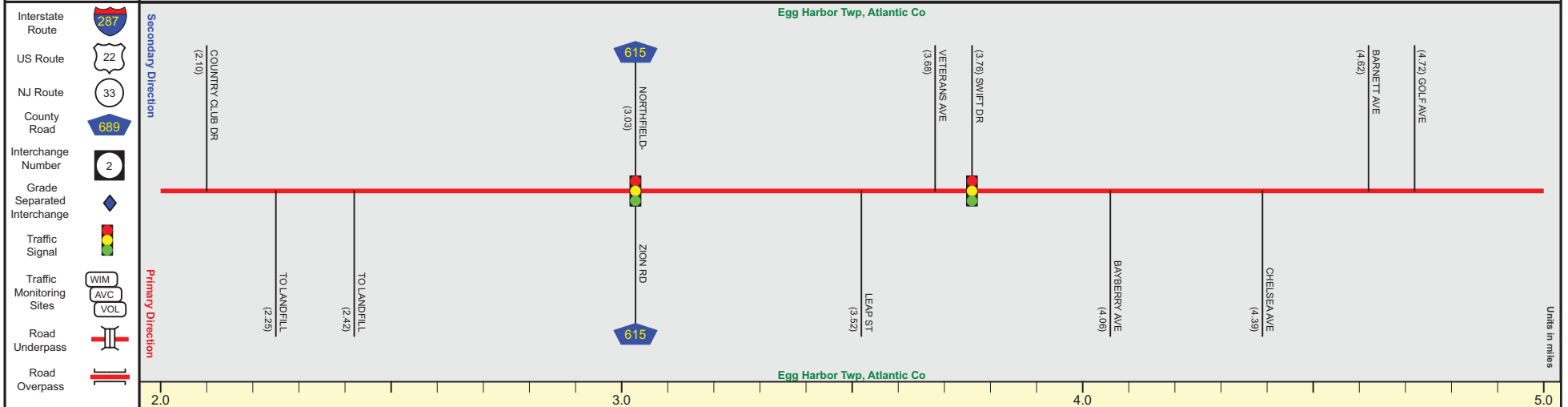

Street Name	Ocean Heights Avenue	
Jurisdiction	County	
Functional Class	Urban Minor Arterial	
Federal Aid - NHS Sy	STP	
Control Section		
Speed Limit	50	
Number of Lanes	2	
Med. Type	None	
Med. Width	0	
Pavement	24	
Shoulder	4	2
Traffic Volume	13,990 (2016)	17,751 (2018)
Traffic Sta. ID	90117	120119
Structure No.		
Enlarged Views		

SRI = 0000559A_

Date last inventoried: June 2012

ROUTE 559 ALTERNATE (South to North)

Mile Posts: 5.000 - 8.000

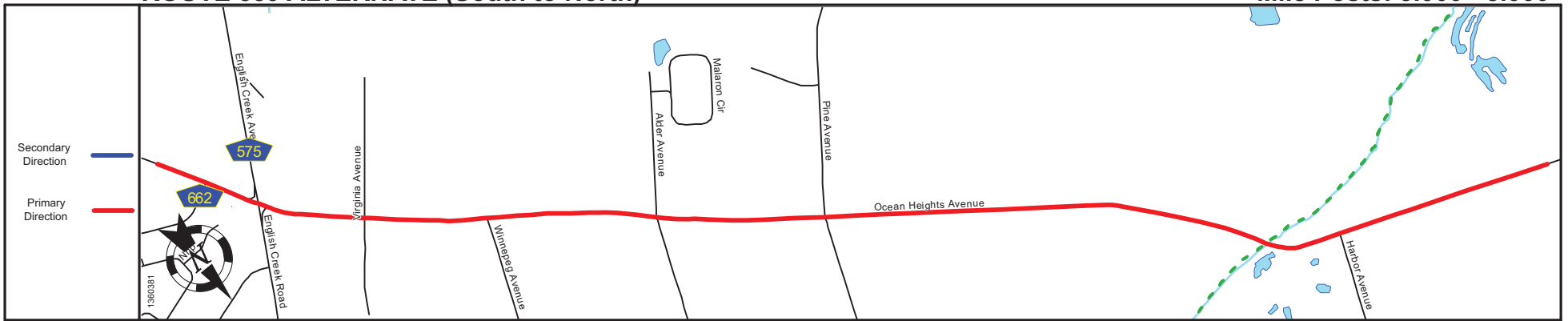

Pavement	
Shoulder	
Number of Lanes	
Speed Limit	
Street Name	

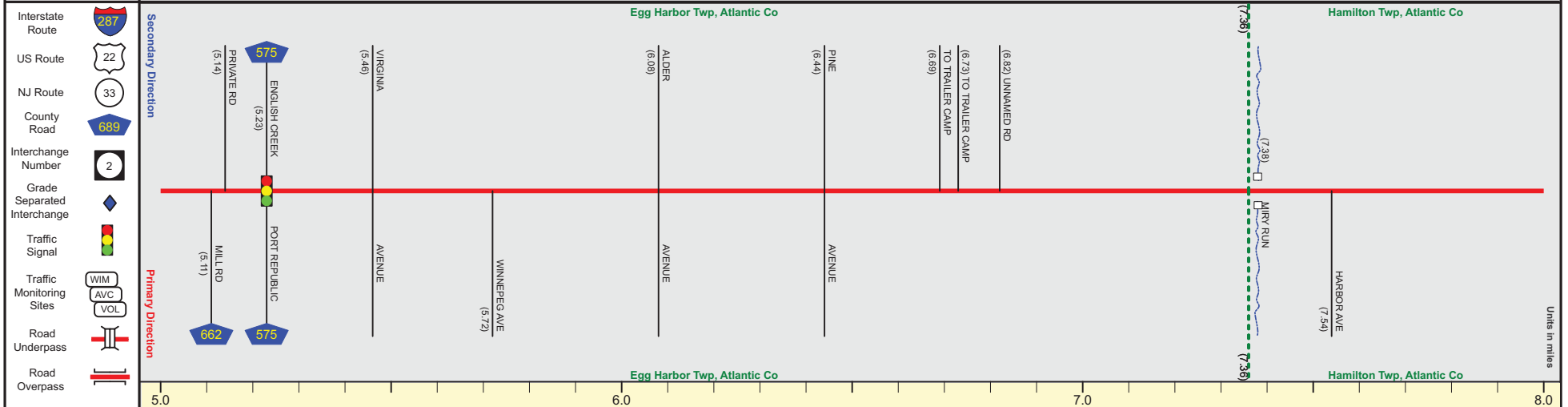

Street Name	Ocean Heights Avenue	
Jurisdiction	County	
Functional Class	Urban Minor Arterial	
Federal Aid - NHS Sy	STP	
Control Section		
Speed Limit	50	
Number of Lanes	2	
Med. Type	None	
Med. Width	0	
Pavement	24	
Shoulder	2	4
Traffic Volume	21,020 (2018)	11,916 (2018)
Traffic Sta. ID	8-8478	8-4439
Structure No.		
Enlarged Views		

SRI = 0000559A_

Date last inventoried: June 2012

ROUTE 559 ALTERNATE (South to North)

Mile Posts: 8.000 - 9.490

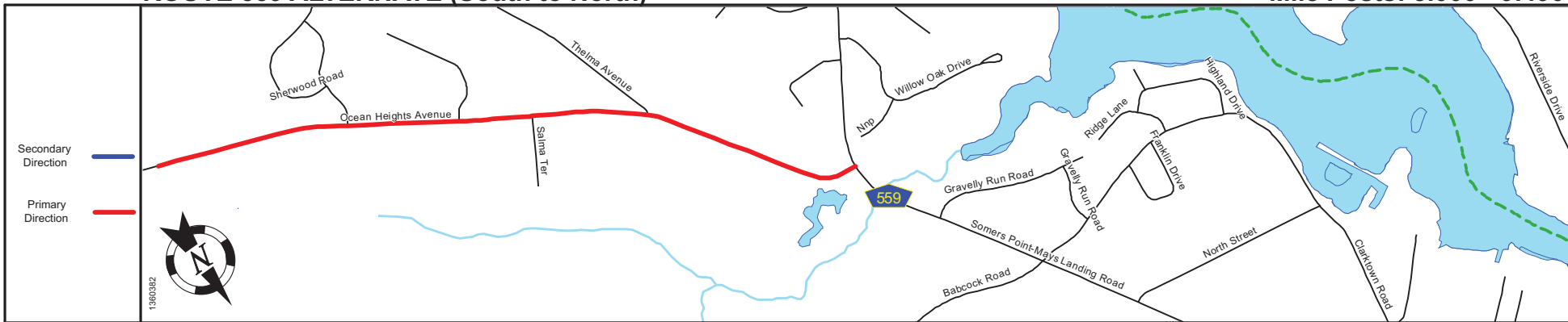

Pavement	
Shoulder	
Number of Lanes	
Speed Limit	
Street Name	

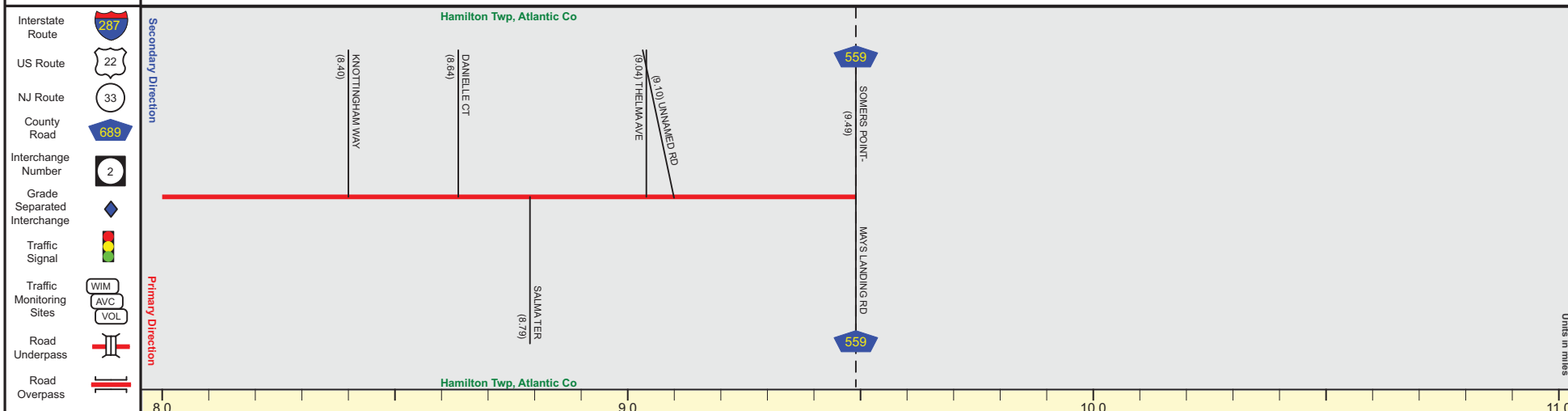

Street Name	Ocean Heights Avenue
Jurisdiction	County
Functional Class	Urban Minor Arterial
Federal Aid - NHS Sy	STP
Control Section	End Rt. 559 Alternate MP 9.49
Speed Limit	50
Number of Lanes	2
Med. Type	None
Med. Width	0
Pavement	24
Shoulder	4
Traffic Volume	8,719 (2016)
Traffic Sta. ID	8-5-409
Structure No.	
Enlarged Views	

SRI = 0000559A_

Date last inventoried: June 2012