

NJ 56 (West to East)

Mile Posts: 0.000 - 2.000

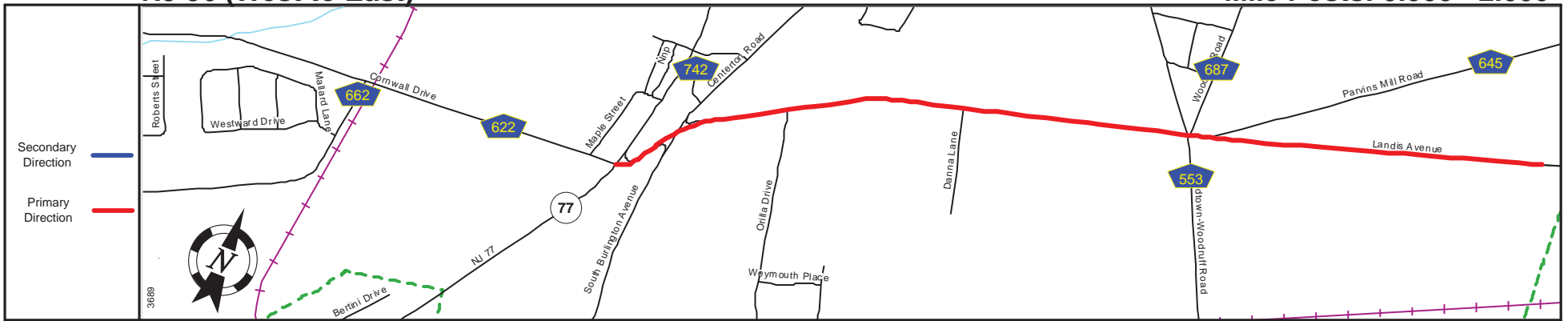

Pavement	
Shoulder	
Number of Lanes	
Speed Limit	
Street Name	

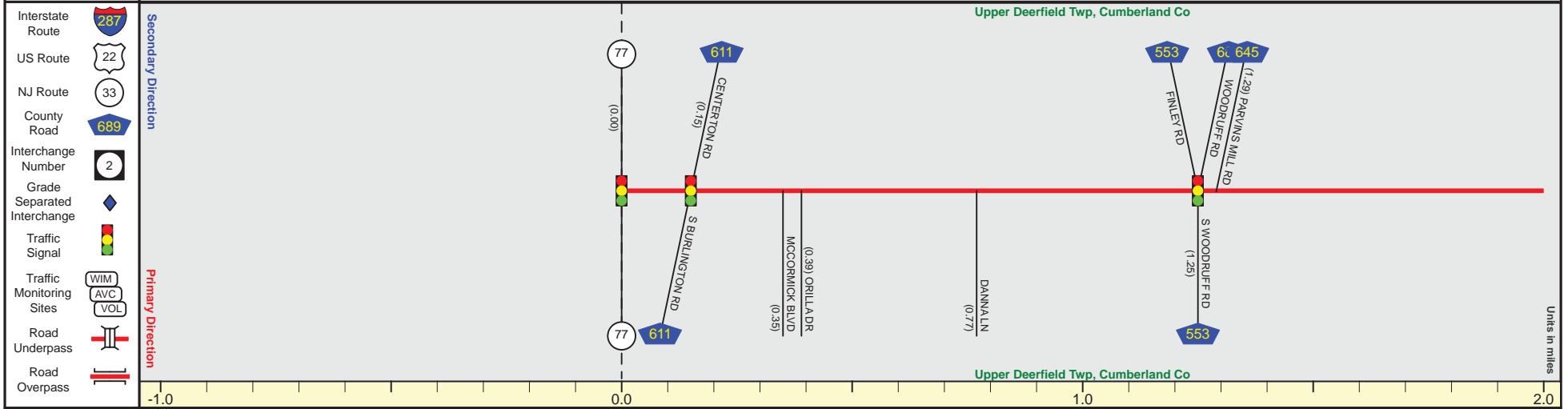

Street Name		Landis Avenue
Jurisdiction		N.J.D.O.T.
Functional Class		Urban Minor Arterial + Rural Minor Arterial
Federal Aid - NHS Sy		STP
Control Section		0611
Speed Limit		50
Number of Lanes	3	2
Med. Type		None
Med. Width		0
Pavement	50	24
Shoulder	0	8
Traffic Volume	10,368 (2012)	
Traffic Sta. ID	7-0-540	
Structure No.		
Enlarged Views		

SRI = 0000056

Date last inventoried: June 2015

NJ 56 (West to East)

Mile Posts: 2.000 - 5.000

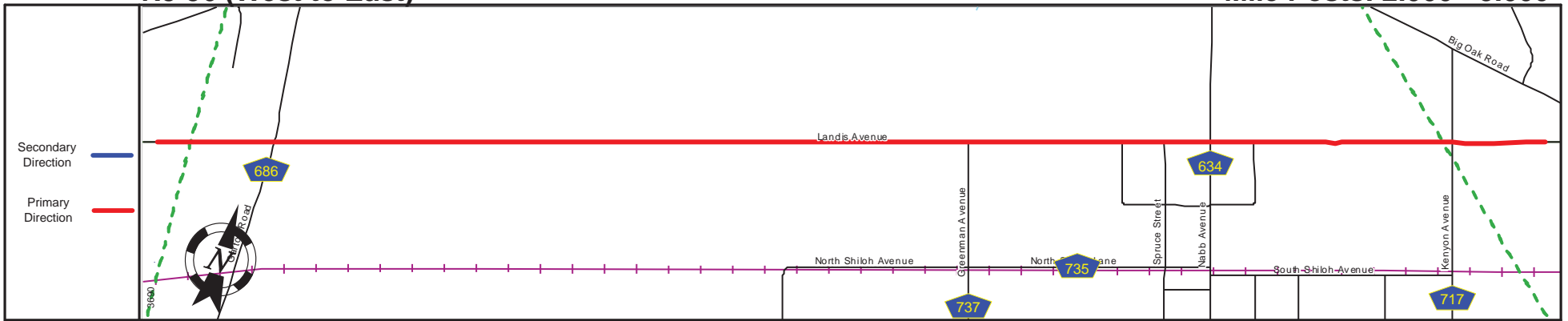

Pavement	
Shoulder	
Number of Lanes	
Speed Limit	
Street Name	

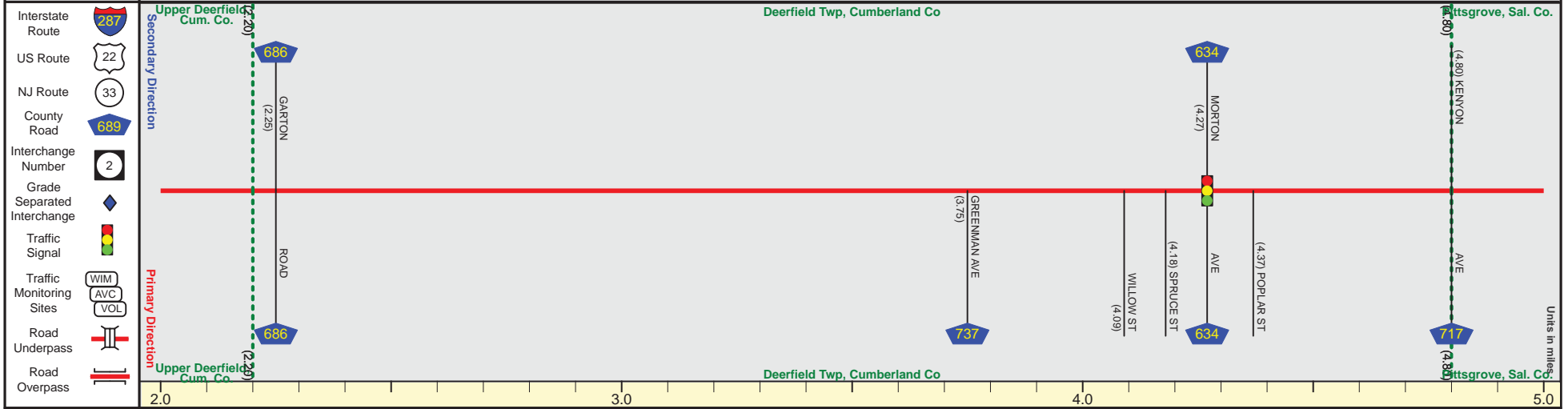

Street Name	Landis Avenue	
Jurisdiction	N.J.D.O.T.	
Functional Class	Rural Minor Arterial	Urban Minor Arterial
Federal Aid - NHS Sy	STP	
Control Section	0611	1716
Speed Limit	50	
Number of Lanes	2	
Med. Type	None	
Med. Width	0	
Pavement	24	
Shoulder	8	
Traffic Volume	7,594 (2011)	
Traffic Sta. ID	7-5-308	
Structure No.		
Enlarged Views		

SRI = 0000056__

Date last inventoried: June 2015

NJ 56 (West to East)

Mile Posts: 5.000 - 8.000

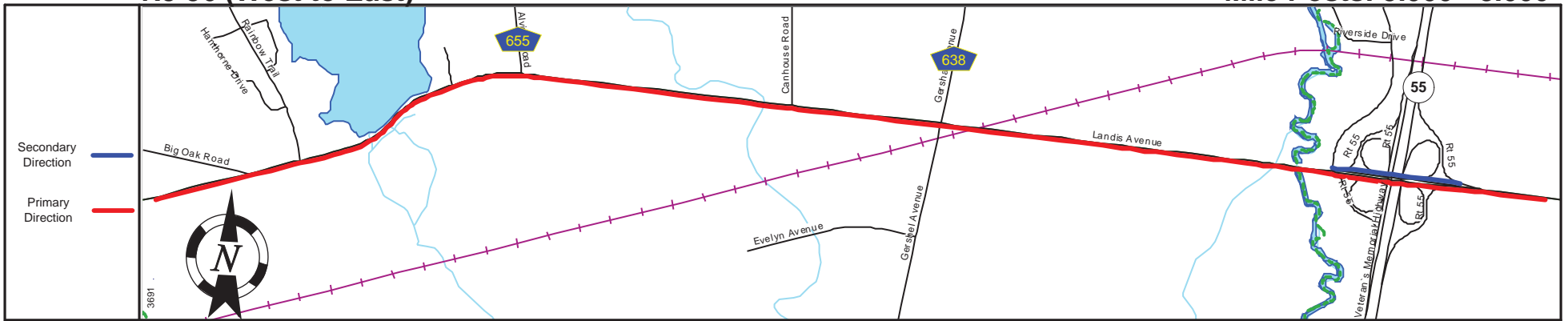

Pavement	24
Shoulder	0
Number of Lanes	2
Speed Limit	50
Street Name	Landis Avenue

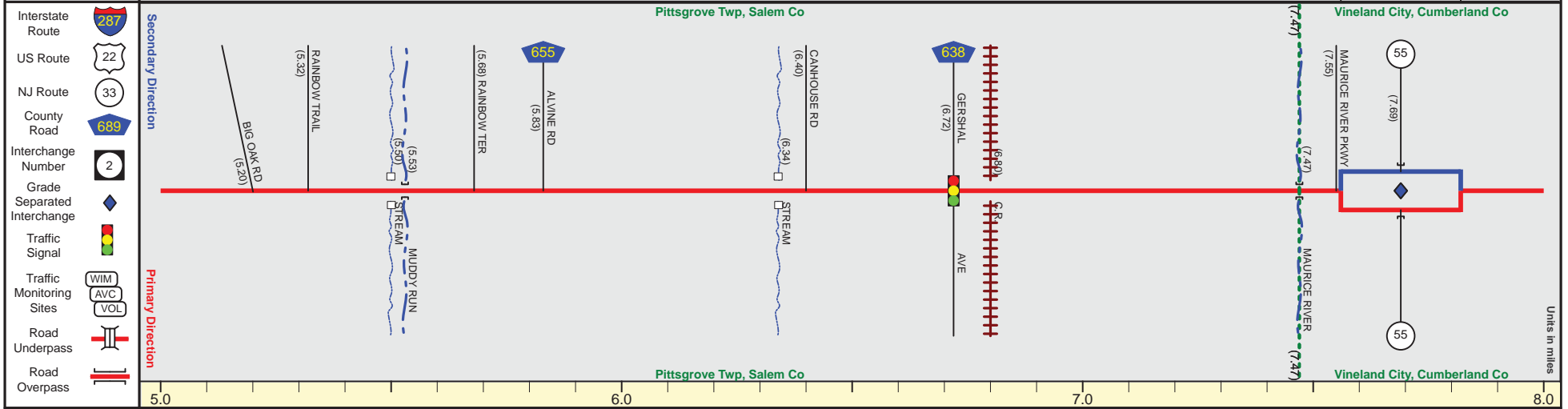

Street Name	Landis Avenue		
Jurisdiction	N.J.D.O.T.		Municipal
Functional Class	Urban Minor Arterial		
Federal Aid - NHS Sy	STP		
Control Section	1716		0612
Speed Limit	50		45
Number of Lanes	2		4
Med. Type	None		Curbed
Med. Width	0		4
Pavement	24		48
Shoulder	8		0
Traffic Volume	12,517 (2011)	11,949 (2012)	13,281 (2011) 13,165 (2011) 14,355 (2011) 13,115 (2011)
Traffic Sta. ID	7-8-085	7-8-086	8-3-0068-3-006 8-3-0068-3-006
Structure No.	1716150 N/A	N/A	1716151 061Q157
Enlarged Views			

SRI = 0000056

Date last inventoried: June 2015

NJ 56 (West to East)

Mile Posts: 8.000 - 9.190

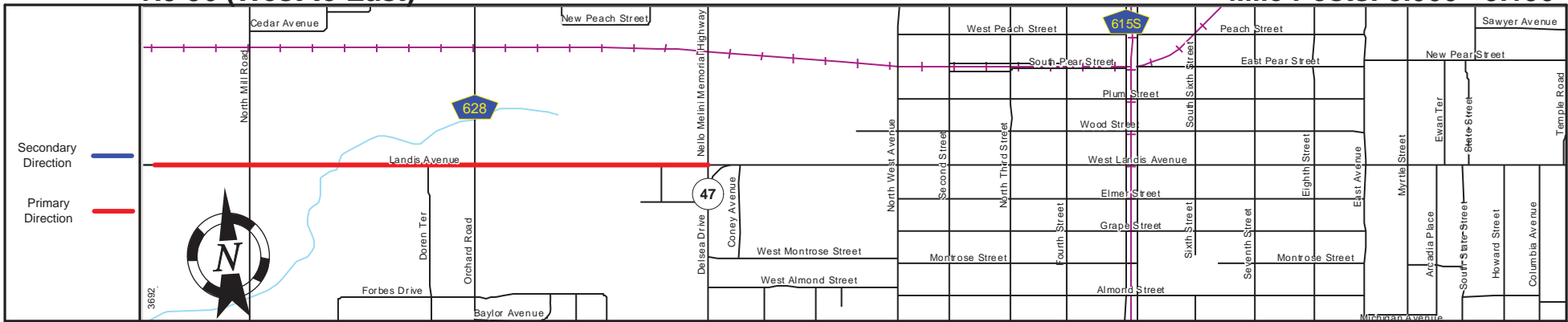

Pavement	24
Shoulder	0
Number of Lanes	2
Speed Limit	45
Street Name	Landis Avenue

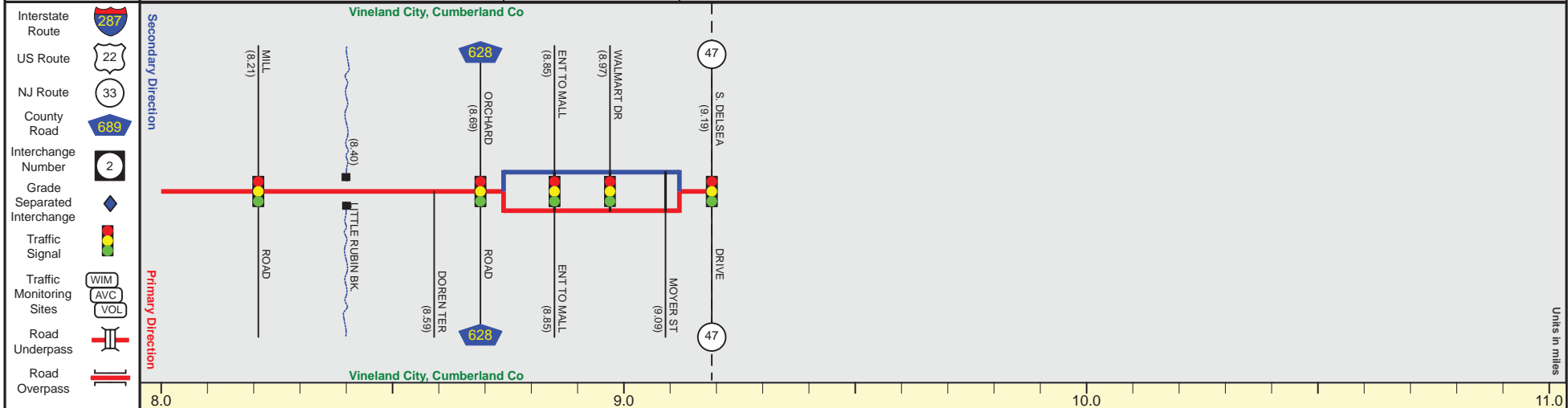

Street Name	Landis Avenue		
Jurisdiction	Municipal		
Functional Class	Urban Minor Arterial		
Federal Aid - NHS Sy	STP		
Control Section	0612		
Speed Limit	45		
Number of Lanes	4		
Med. Type	None	Painted/Unprotected	None
Med. Width	0	12	0
Pavement	48	24	60
Shoulder	0		8
Traffic Volume	17,943 (2010)		
Traffic Sta. ID	8-8-058		
Structure No.	0612150		
Enlarged Views			

SRI = 0000056

Date last inventoried: June 2015