

# ROUTE 559 ALTERNATE (South to North)

Mile Posts: 0.000 - 2.000

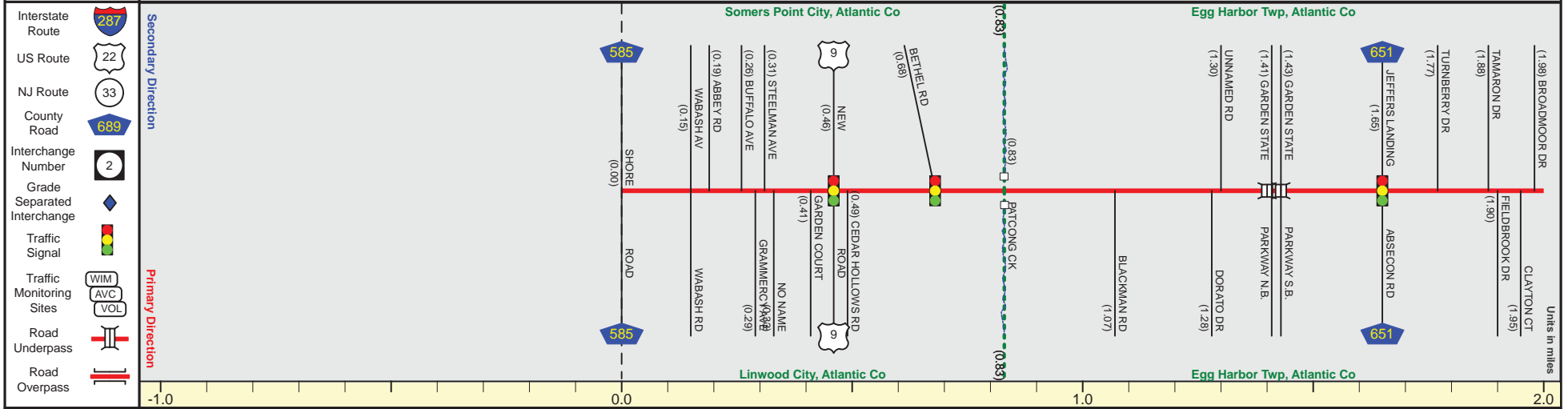

|                 |  |
|-----------------|--|
| Pavement        |  |
| Shoulder        |  |
| Number of Lanes |  |
| Speed Limit     |  |
| Street Name     |  |



|                      |                                 |                      |
|----------------------|---------------------------------|----------------------|
| Street Name          | Ocean Heights Avenue            |                      |
| Jurisdiction         | County                          |                      |
| Functional Class     | Urban Major Collector           | Urban Minor Arterial |
| Federal Aid - NHS Sy | STP                             |                      |
| Control Section      | Begin Rt. 559 Alternate MP=0.00 |                      |
| Speed Limit          | 25                              | 35                   |
| Number of Lanes      | 2                               |                      |
| Med. Type            | None                            |                      |
| Med. Width           | 0                               |                      |
| Pavement             | 24                              | 22                   |
| Shoulder             | 1                               | 4                    |
| Traffic Volume       | 6,816 (2012)                    | 15,870 (2011)        |
| Traffic Sta. ID      | 8-8-282                         | 8-8-294              |
| Structure No.        | N/A                             |                      |
| Enlarged Views       | 360316N<br>360316S              |                      |

SRI = 0000559A\_

Date last inventoried: June 2012

# ROUTE 559 ALTERNATE (South to North)

Mile Posts: 2.000 - 5.000

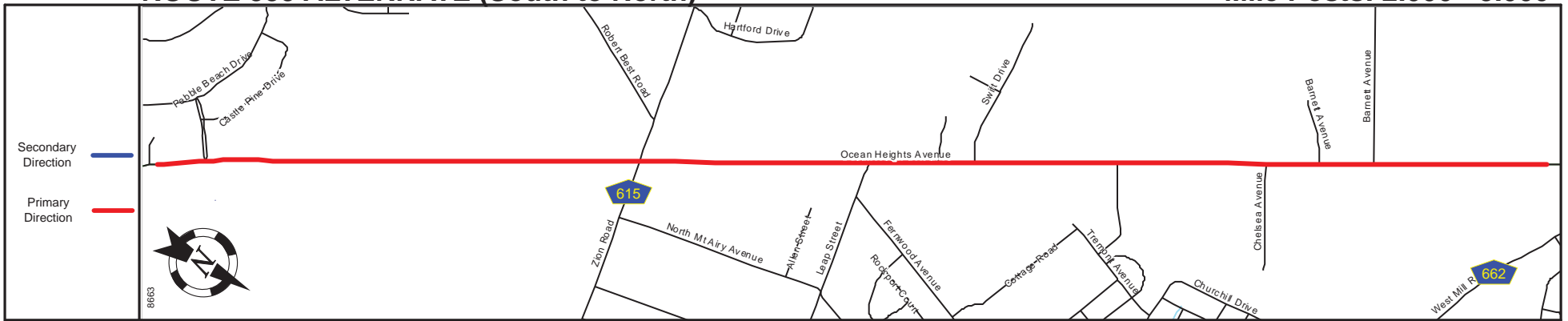

|                 |  |
|-----------------|--|
| Pavement        |  |
| Shoulder        |  |
| Number of Lanes |  |
| Speed Limit     |  |
| Street Name     |  |

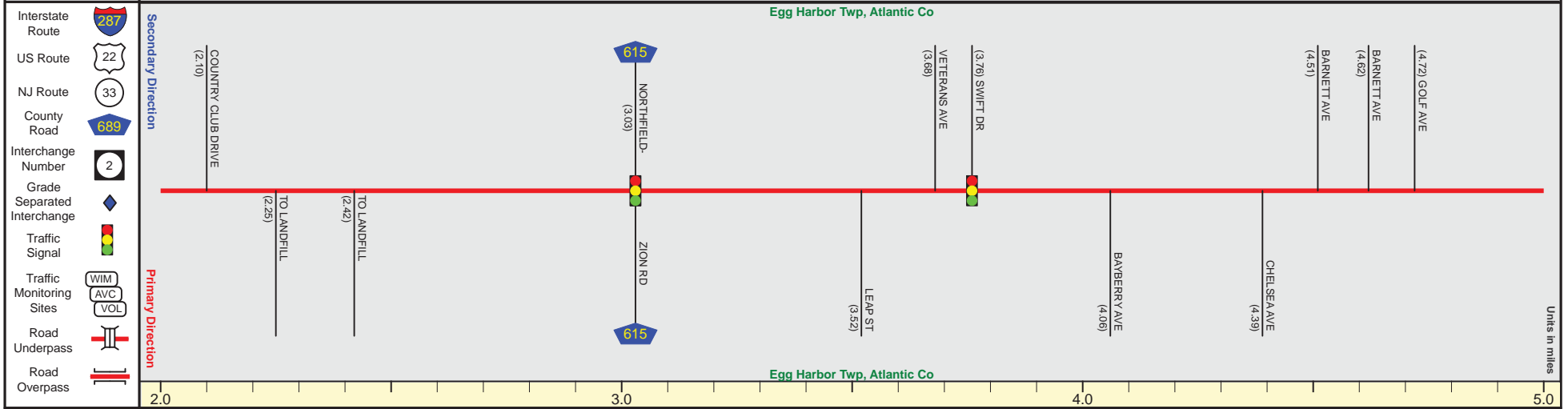

|                      |                      |   |
|----------------------|----------------------|---|
| Street Name          | Ocean Heights Avenue |   |
| Jurisdiction         | County               |   |
| Functional Class     | Urban Minor Arterial |   |
| Federal Aid - NHS Sy | STP                  |   |
| Control Section      |                      |   |
| Speed Limit          | 50                   |   |
| Number of Lanes      | 2                    |   |
| Med. Type            | None                 |   |
| Med. Width           | 0                    |   |
| Pavement             | 24                   |   |
| Shoulder             | 4                    | 2 |
| Traffic Volume       | 17,042 (2012)        |   |
| Traffic Sta. ID      | 120119               |   |
| Structure No.        |                      |   |
| Enlarged Views       |                      |   |

SRI = 0000559A\_

Date last inventoried: June 2012

# ROUTE 559 ALTERNATE (South to North)

Mile Posts: 5.000 - 8.000

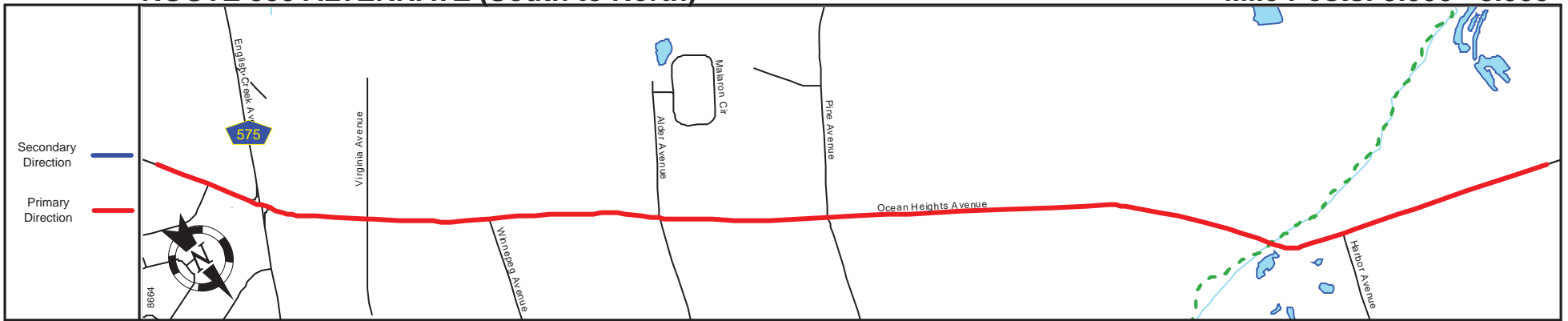

|                 |  |
|-----------------|--|
| Pavement        |  |
| Shoulder        |  |
| Number of Lanes |  |
| Speed Limit     |  |
| Street Name     |  |

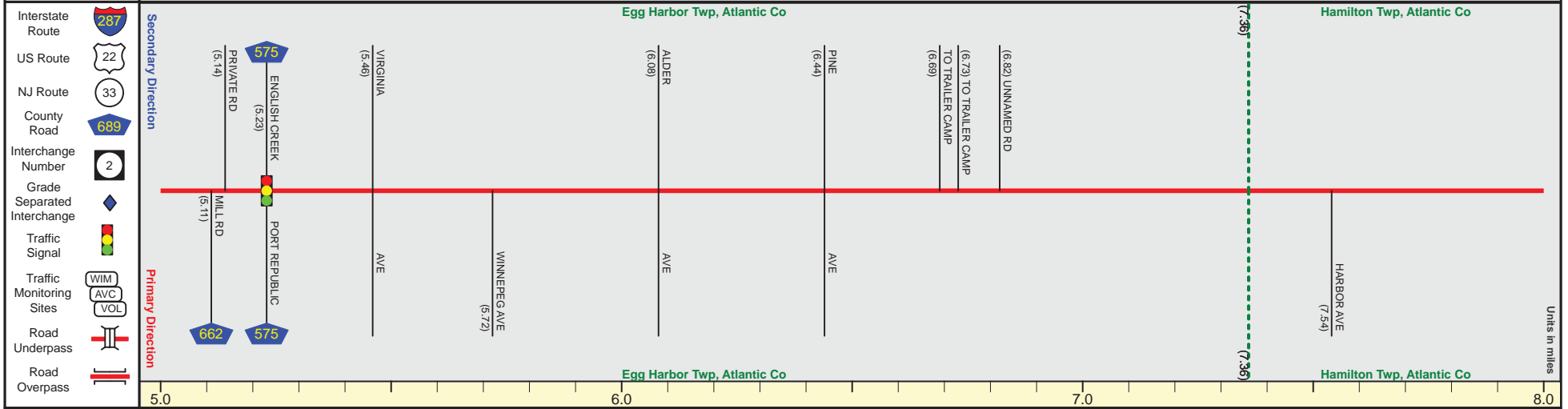

|                      |                      |               |
|----------------------|----------------------|---------------|
| Street Name          | Ocean Heights Avenue |               |
| Jurisdiction         | County               |               |
| Functional Class     | Urban Minor Arterial |               |
| Federal Aid - NHS Sy | STP                  |               |
| Control Section      |                      |               |
| Speed Limit          | 50                   |               |
| Number of Lanes      | 2                    |               |
| Med. Type            | None                 |               |
| Med. Width           | 0                    |               |
| Pavement             | 24                   |               |
| Shoulder             | 2                    | 4             |
| Traffic Volume       | 14,968,(2012)        | 11,880,(2012) |
| Traffic Sta. ID      | 8-8,478              | 8-4,439       |
| Structure No.        |                      |               |
| Enlarged Views       |                      |               |

SRI = 0000559A\_

Date last inventoried: June 2012

# ROUTE 559 ALTERNATE (South to North)

Mile Posts: 8.000 - 9.490

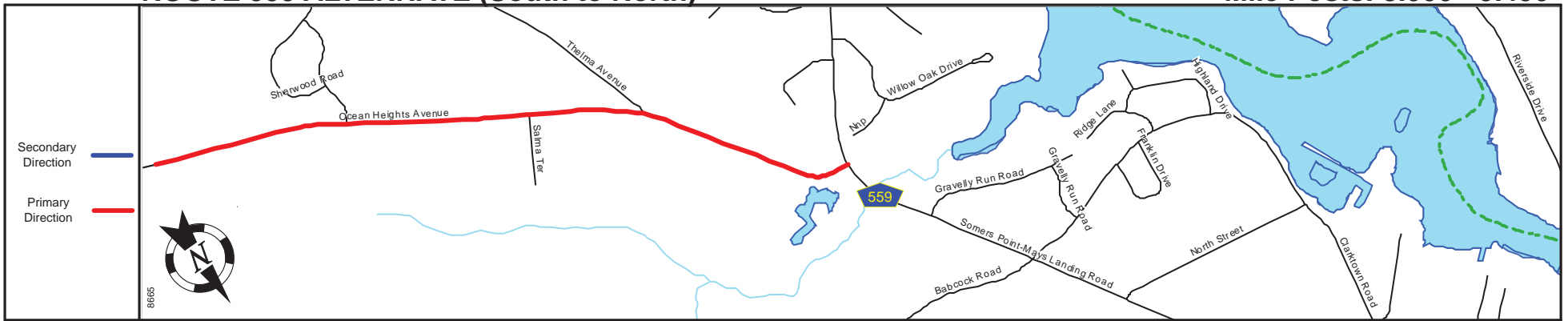

|                 |  |
|-----------------|--|
| Pavement        |  |
| Shoulder        |  |
| Number of Lanes |  |
| Speed Limit     |  |
| Street Name     |  |

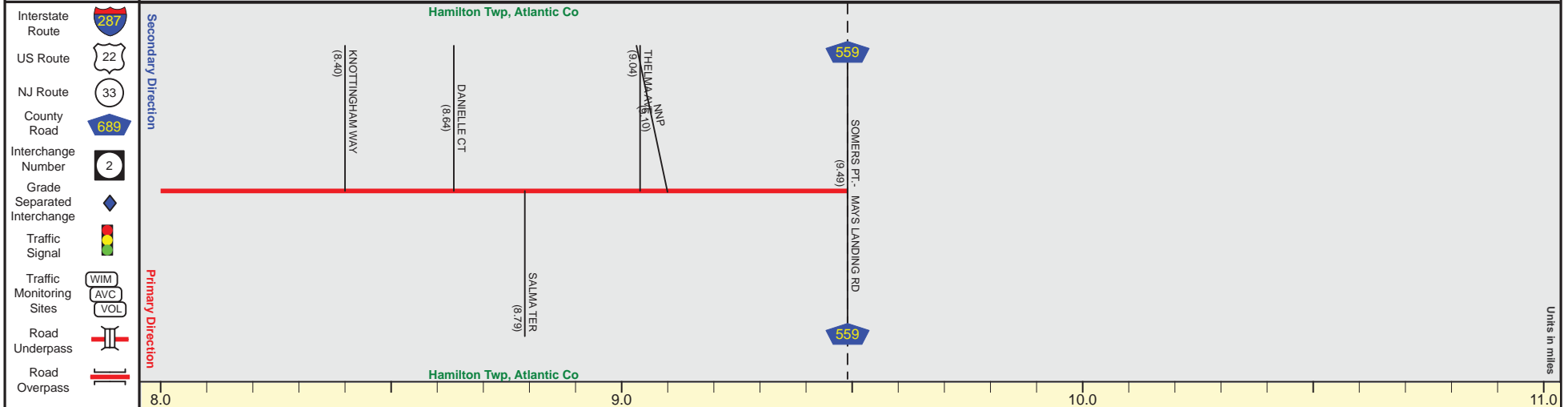

|                      |                      |  |
|----------------------|----------------------|--|
| Street Name          | Ocean Heights Avenue |  |
| Jurisdiction         | County               |  |
| Functional Class     | Urban Minor Arterial |  |
| Federal Aid - NHS Sy | STP                  |  |
| Control Section      |                      |  |
| Speed Limit          | 50                   |  |
| Number of Lanes      | 2                    |  |
| Med. Type            | None                 |  |
| Med. Width           | 0                    |  |
| Pavement             | 24                   |  |
| Shoulder             | 4                    |  |
| Traffic Volume       | 8,311 (2013)         |  |
| Traffic Sta. ID      | 8-5-409              |  |
| Structure No.        |                      |  |
| Enlarged Views       |                      |  |

SRI = 0000559A\_

Date last inventoried: June 2012