

BERGEN COUNTY S91 (South to North)

Mile Posts: 0.000 - 2.000

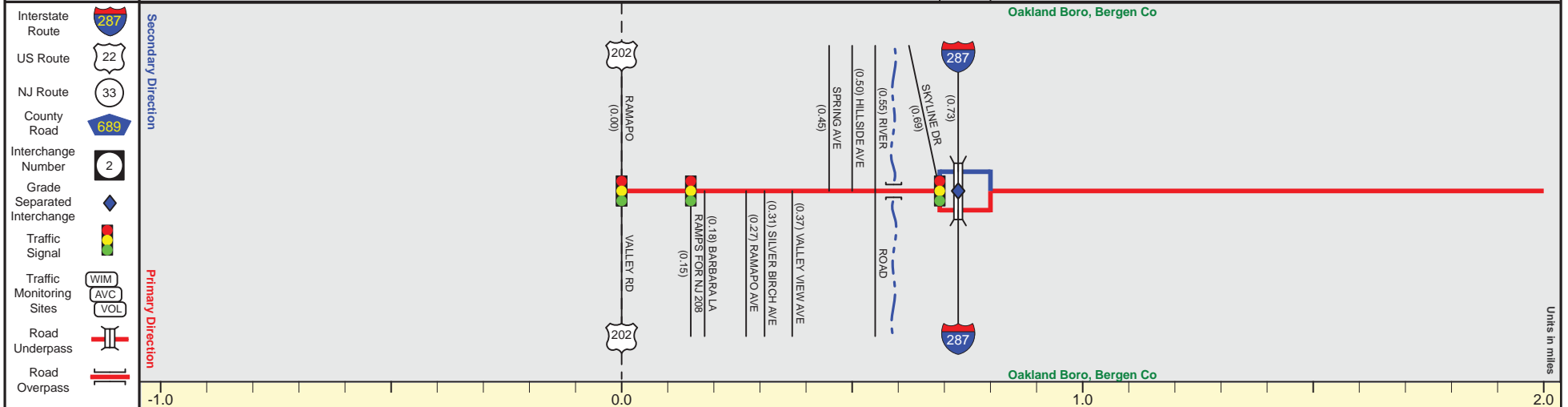

Pavement	22
Shoulder	0
Number of Lanes	1
Speed Limit	35
Street Name	Skyline Drive



Street Name	West Oakland Avenue		Skyline Drive	
Jurisdiction	County			
Functional Class	Urban Minor Arterial			
Federal Aid - NHS Sy	STP			
Control Section	Begin Bergen County S91 MP=0.00			
Speed Limit	NOT POSTED	35		40
Number of Lanes	4	2	1	2
Med. Type		None	Positive	None
Med. Width		0	VAR	0
Pavement	36	24	28	22
Shoulder	0	1	0	1
Traffic Volume	17,947 (2013)			
Traffic Sta. ID	12Q2d6			
Structure No.				
Enlarged Views				

SRI = 02000S91__

Date last inventoried: September 2011

BERGEN COUNTY S91 (South to North)

Mile Posts: 2.000 - 2.490

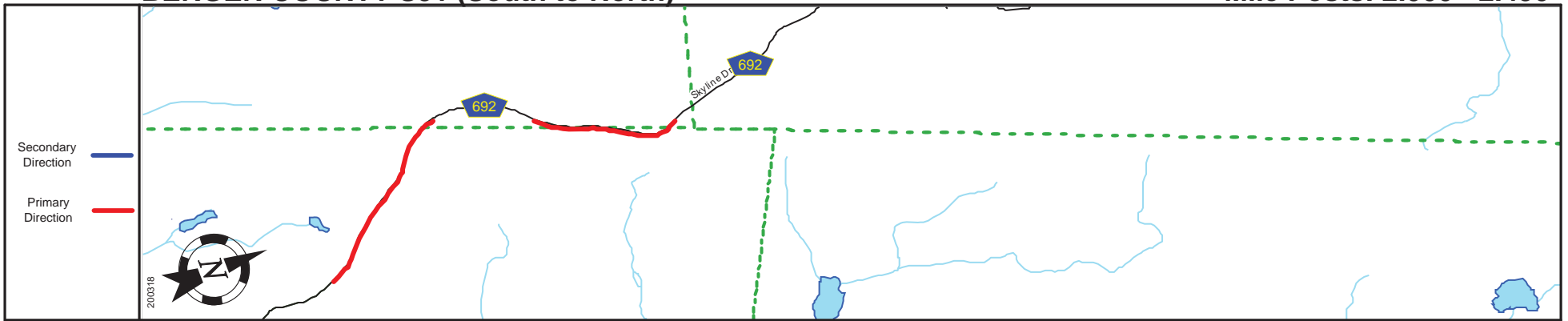

Pavement	
Shoulder	
Number of Lanes	
Speed Limit	
Street Name	

<ul style="list-style-type: none"> Interstate Route US Route NJ Route County Road Interchange Number Grade Separated Interchange Traffic Signal Traffic Monitoring Sites Road Underpass Road Overpass 	<p>Oakland Boro, Bergen Co</p> <p>Secondary Direction</p> <p>End at Passaic County Line</p> <p>Primary Direction</p> <p>Oakland Boro, Bergen Co</p>	Units in miles

Street Name	Skyline Drive	
Jurisdiction	County	
Functional Class	Urban Minor Arterial	
Federal Aid - NHS Sy	STP	
Control Section		
Speed Limit	40	
Number of Lanes	2	
Med. Type	None	
Med. Width	0	
Pavement	28	
Shoulder	1	
Traffic Volume		
Traffic Sta. ID		
Structure No.		
Enlarged Views		

MP 2.49 = Begin Passaic Co 692 MP=0.00
 MP 2.49-2.76 See Passaic Co 692 MP 0.00-0.27

SRI = 02000S91__

Date last inventoried: September 2011

BERGEN COUNTY S91 (South to North)

Mile Posts: 2.760 - 3.140

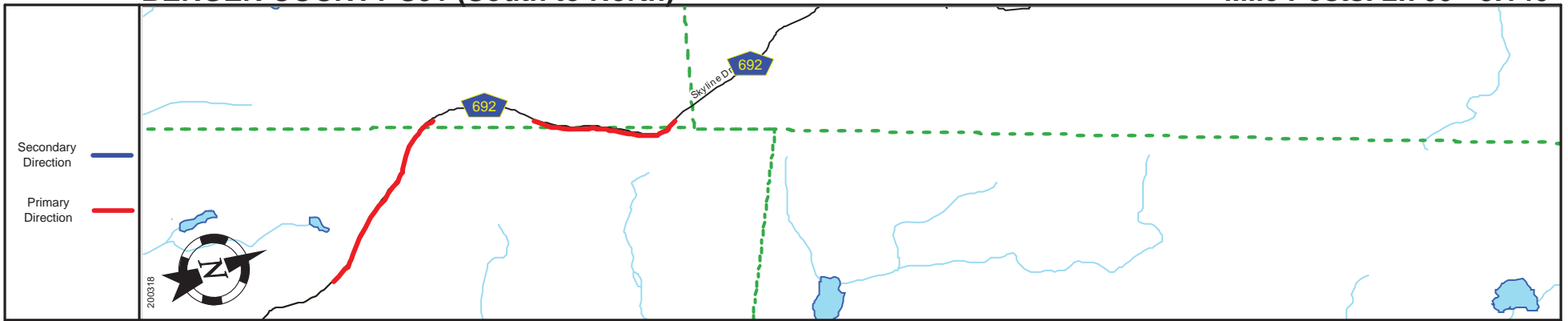

Pavement	
Shoulder	
Number of Lanes	
Speed Limit	
Street Name	

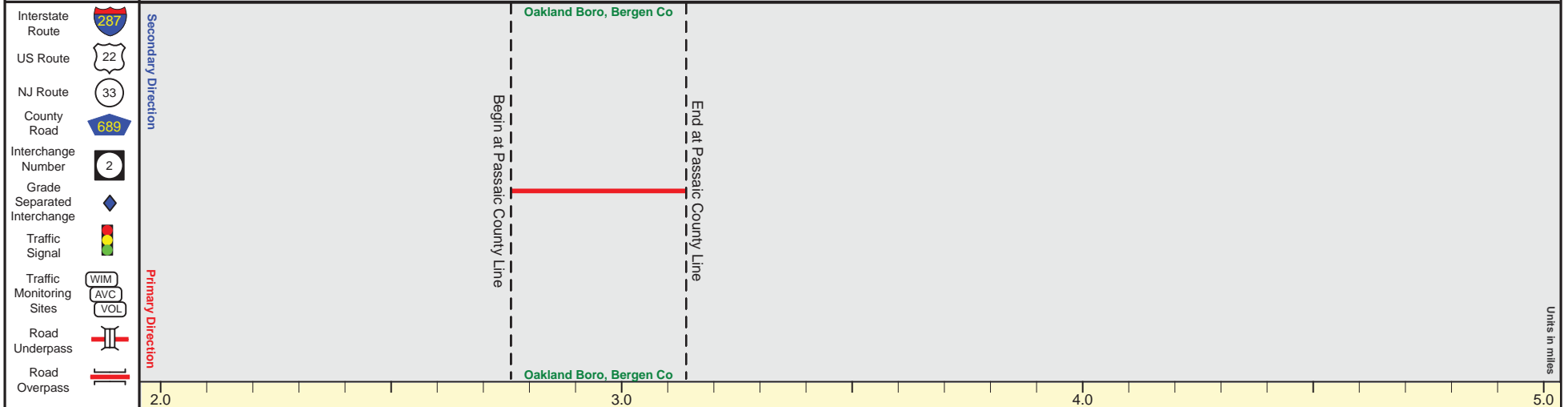

Street Name	Skyline Drive
Jurisdiction	County
Functional Class	Urban Minor Arterial
Federal Aid - NHS Sy	STP
Control Section	
Speed Limit	40
Number of Lanes	2
Med. Type	None
Med. Width	0
Pavement	28
Shoulder	1
Traffic Volume	
Traffic Sta. ID	
Structure No.	
Enlarged Views	

SRI = 02000S91__

Date last inventoried: September 2011