

CUMBERLAND COUNTY 655 (South to North)

Mile Posts: 0.000 - 2.000

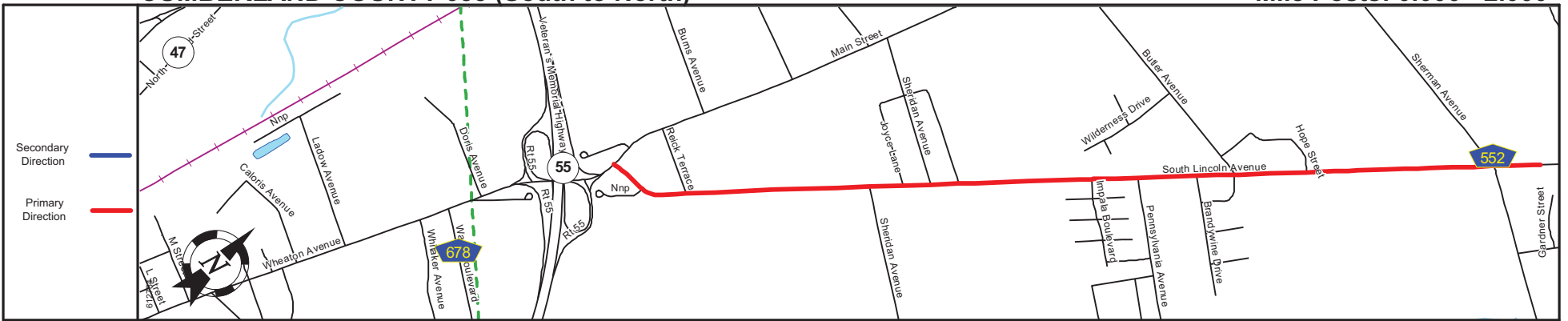

Pavement	
Shoulder	
Number of Lanes	
Speed Limit	
Street Name	

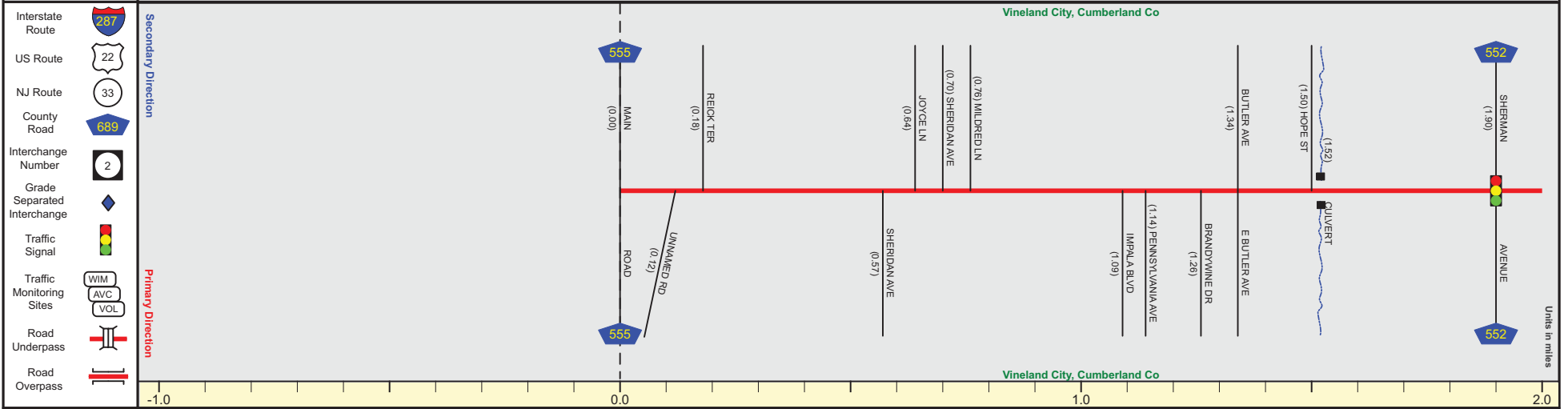

Street Name	South Lincoln Avenue	
Jurisdiction	County	
Functional Class	Urban Minor Arterial	
Federal Aid - NHS Sy	STP	
Control Section		
Speed Limit	25	50
Number of Lanes	2	
Med. Type	None	
Med. Width	0	
Pavement	48	24
Shoulder	0	6
Traffic Volume	9,008 (2017)	
Traffic Sta. ID	110625	
Structure No.		
Enlarged Views		

SRI = 0600655__

Date last inventoried: July 2011

CUMBERLAND COUNTY 655 (South to North)

Mile Posts: 2.000 - 5.000

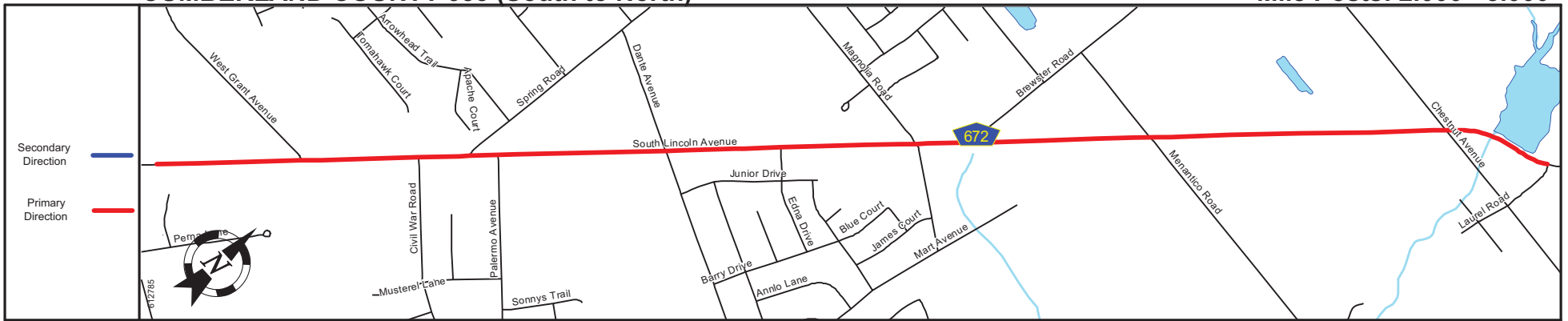

Pavement	
Shoulder	
Number of Lanes	
Speed Limit	
Street Name	

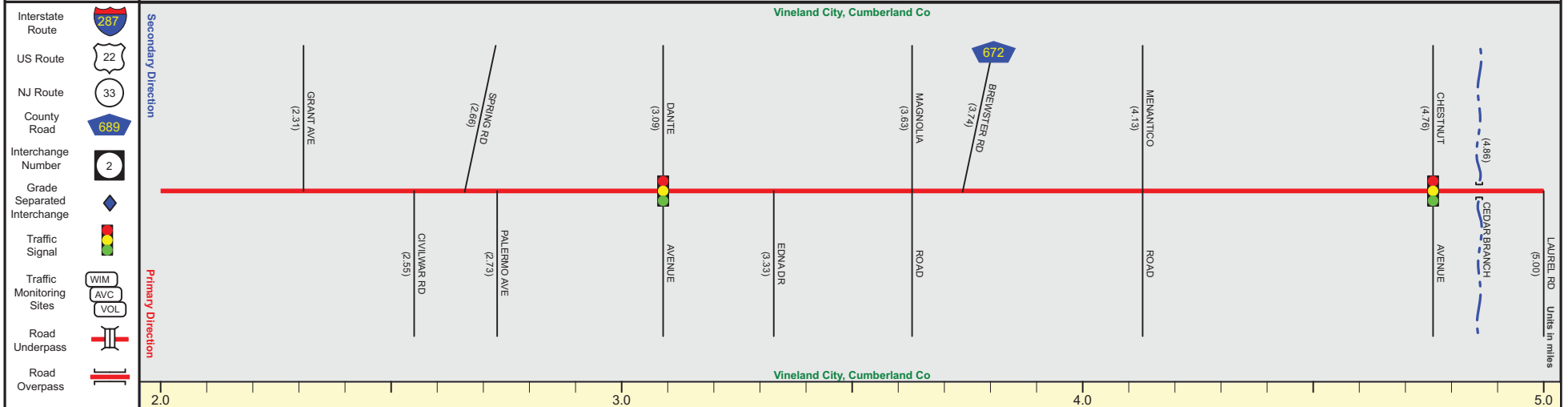

Street Name	South Lincoln Avenue		
Jurisdiction	County		
Functional Class	Urban Minor Arterial		
Federal Aid - NHS Sy	STP		
Control Section			
Speed Limit	50	40	50
Number of Lanes	2		
Med. Type	None		
Med. Width	0		
Pavement	24		
Shoulder	6	8	6
Traffic Volume	13,340 (2017)	15,606 (2018)	9,551 (2017)
Traffic Sta. ID	8-8-085	8-8-086	8-8-088
Structure No.	LS-54		
Enlarged Views			

SRI = 0600655__

Date last inventoried: July 2011

CUMBERLAND COUNTY 655 (South to North)

Mile Posts: 5.000 - 6.080

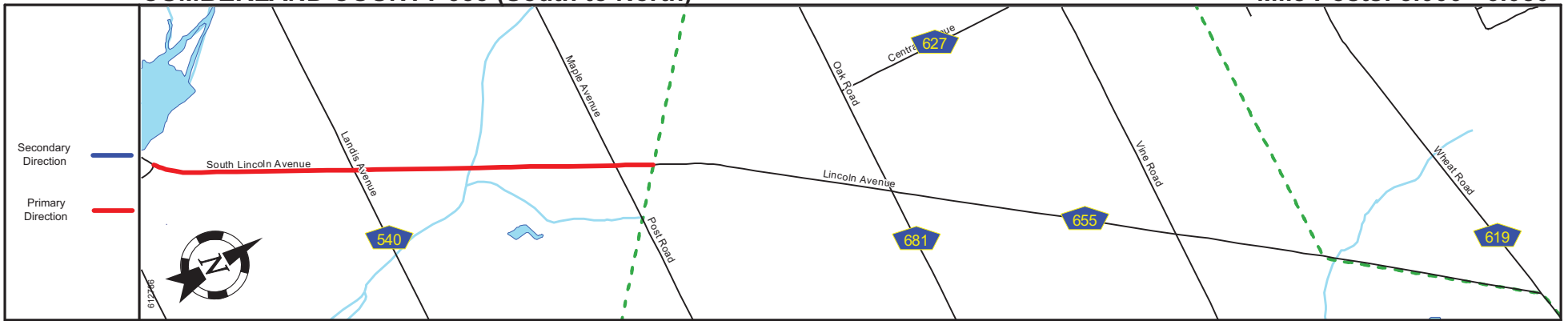

Pavement	
Shoulder	
Number of Lanes	
Speed Limit	
Street Name	

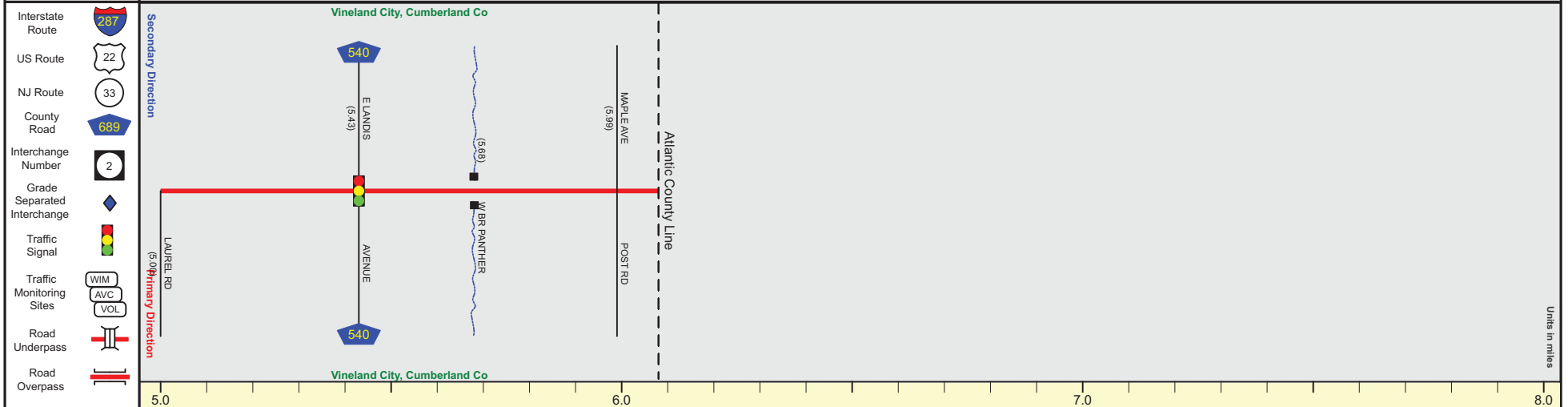

Street Name	South Lincoln Avenue		
Jurisdiction	County		
Functional Class	Urban Minor Arterial		
Federal Aid - NHS Sy	STP		
Control Section			
Speed Limit	50		
Number of Lanes	2		
Med. Type	None		
Med. Width	0		
Pavement	24	48	24
Shoulder	6	0	8
Traffic Volume			
Traffic Sta. ID			
Structure No.			
Enlarged Views			

End Cumberland County 655 MP=6.08

SRI = 0600655__

Date last inventoried: July 2011